

DEMA®

910

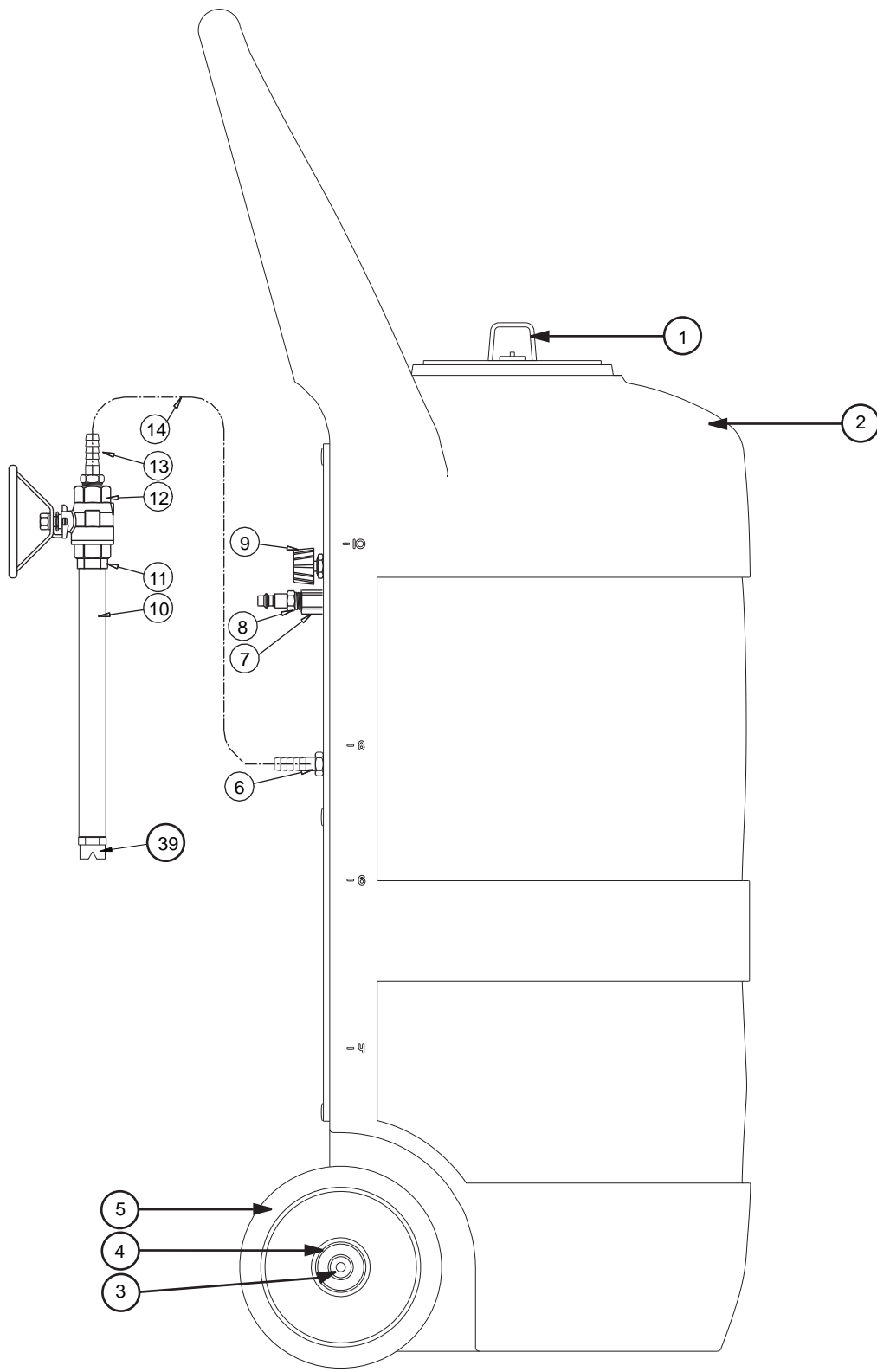

OWNER'S MANUAL



SIDE VIEW

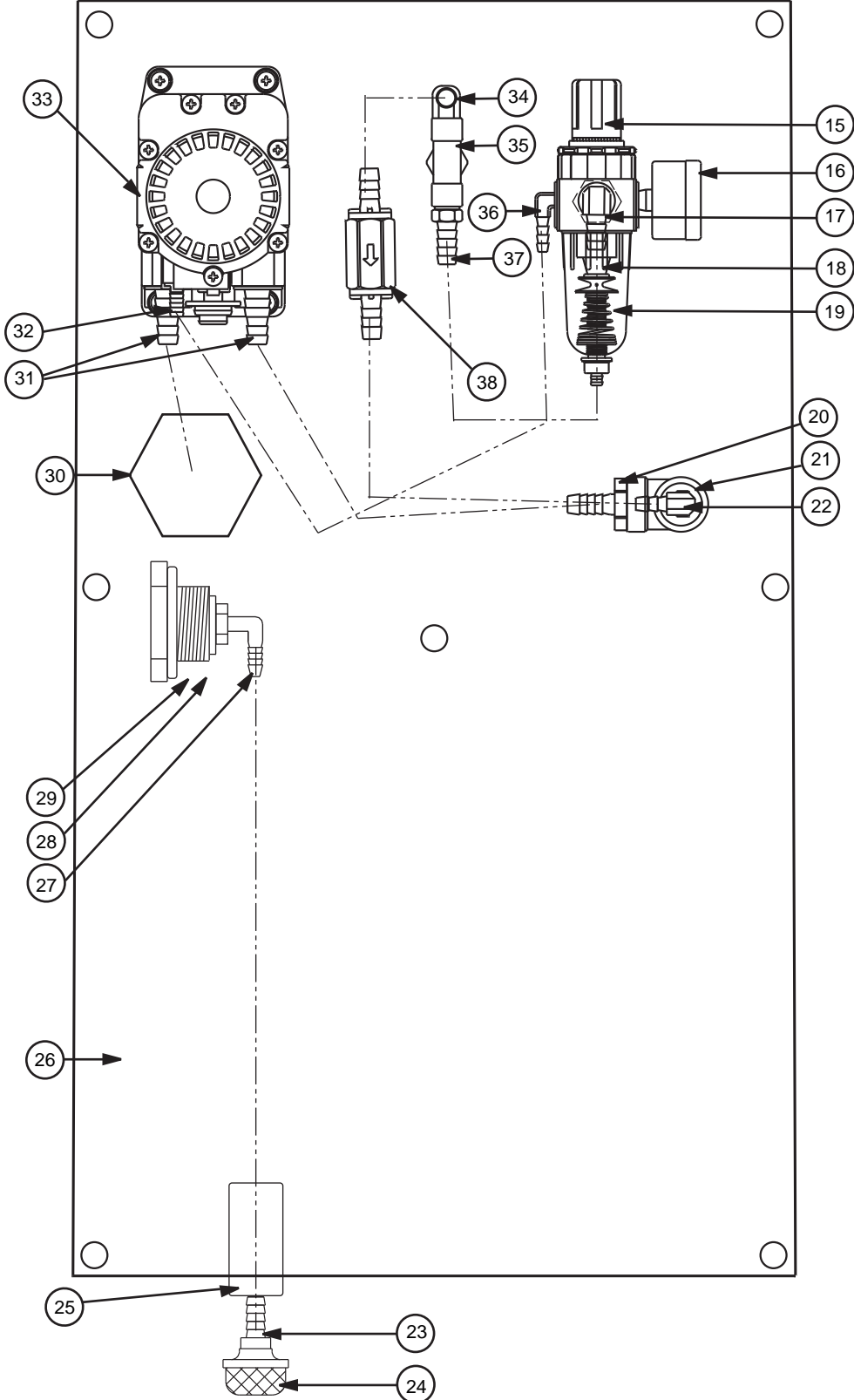

INSIDE VIEW - CONTROL PANEL



PARTS LIST

PARTS LIST

ITEM	PART NO.	DESCRIPTION
1	DFP6	6 INCH THREADED CAP FOR 10 GALLON UNIT
2	TANK 10	10 GALLON ROTOMOLDED TANK
3	AXC12	1/2in PUSH NUT FOR AXLE CAP
4	SSAXLE12	12 9/16IN x 1/2IN STAINLESS STEEL AXLE FOR 10 GALLON UNIT
5	W10	6 in wheel X 1.25 in TPR Celcon Brg 1/2 in Axle
6	HBSS1212	STAINLESS HOSE BARB 1/2 X 1/2
7	BA25	MALE/FEMALE ADAPTER 1/4 X 1/4
8	AP25	PLUG 1/4 NPTM AIR FITTING - BRASS
9	NV14Y-HNDL	KNOB FOR 2839-1/4 NEEDLE VALVE
10	PW10	3/4in BLACK POLY PRO X 10in - FPTBE - SCH.80
11	HHSB1214	HEX HEAD S.S. REDUCER BUSHING 1/2 X 1/4
12	HV60	1/2in STAINLESS BALL VALVE - w/ WELDED NUT
13	HBSS1212	STAINLESS HOSE BARB 1/2 X 1/2
14	H12-20	20FT OF 1/2in BLUE HOSE REPLACEMENT
15	R15	FILTER REGULATOR COMBO INCLUDES AFR15 AND ABR15
16	AG100	1.5in DRY MODEL 20 DUAL SCALE GAUGE
17	HBBEL1438	3/8 BRASS HOSE BARB X 1/4 PIPE ELB
18	AFR15	ORIGA FILTER ELEMENT
19	ABR15	ORIGA BOWL W/SEMIAUTO DRAIN
20	HBSS1238	STAINLESS HOSE BARB 1/2 X 3/8
21	SST12	1/2in FPT 304 S.S. TEE
22	HBSSSEL1238	304 S.S. 1/2in MPT BY 3/8in H.B. ELBOW
23	HB1438	1/4in MPT X 3/8in HOSE BARB (PLASTIC)
24	STR14	40 MESH SUCTION LINE STRAINER
25	SHW3	3in LONG COATED WEIGHT
26	PL10-12	PLASTIC PLATE FOR FI-10 UNIT
27	HBEL1238	HOSE BARB ELBOW 1/2 X 3/8
28	DPG-10	BULKHEAD GASKET
29	DP-10	BULKHEAD BODY 1/2 FPT
30	DPN-10	BULKHEAD RETAINING NUT
31	HB5638	HOSE BARB FOR P56 PUMP
32	HB14P	1/4in BRASS HB AIR FITTING
33	P56	5700 SANTO PUMP
34	HBBEL1438	3/8 BRASS HOSE BARB X 1/4 PIPE ELB
35	NV14Y	FLOW CONTROL VALVE INCLUDED NY14Y-HNDL
36	HBBEL1814	1/8 MPT X 1/4 HOSE BARB BRASS 90DEG
37	HBB1438	BRASS 1/4 MPT X 3/8 HOSE BARB
38	CV38	PVC CHECK VALVE 3/8 BARBS - SS SPRING
39	ST80100	VEEJET NOZZLE, BRASS 80100



SAFETY INSTRUCTIONS

1. ALWAYS WEAR SAFETY GOGGLES AND PROTECTIVE GLOVES WHILE OPERATING FOAM UNIT.
2. AVOID CONTACT OF CLEANING AGENT WITH SKIN AND EYES. IF CONTACT OCCURS RINSE AFFECTED AREA WITH WATER FOR 15 MINUTES AND GET MEDICAL ATTENTION IF NEEDED.
3. AFTER USE, RELIEVE ALL REMAINING PRESSURE IN THE SYSTEM BY UNPLUGGING THE AIR LINE FROM THE UNIT (AP25) AND OPENING THE DISCHARGE BALL VALVE (HV60) .
4. NEVER POINT THE DISCHARGE WAND AT ANYONE.
5. BE SURE TO FLUSH THE UNIT WITH FRESH WATER FOR 5 MINUTES WHEN SWITCHING FROM AN ALKALINE TO AN ACID OR AN ACID TO AN ALKALINE.

OPERATION INSTRUCTIONS

1. FILL THE DRUM WITH COMBINATION OF WATER AND FOAMING CHEMICAL, 4 - 6 OZ. PER GALLON OF WATER IS RECOMMENDED.
2. WITH BALL VALVE (HV60) IN THE CLOSED POSITION, PLUG AN AIR LINE INTO THE AIR FITTING (AP25) .
3. SLOWLY OPEN THE BALL VALVE (HV60) .
4. ADJUST THE **WET FOAM / DRY FOAM** VALVE (NV14Y) TO DESIRED WETNESS OR DRYNESS OF FOAM FOLLOWING THE STEPS BELOW:
 - A. CLOSE VALVE COMPLETELY IN CLOCKWISE DIRECTION.
 - B. OPEN VALVE IN COUNTER-CLOCKWISE DIRECTION 3 COMPLETE TURNS.
 - C. CONTINUE TO OPEN VALVE IN 1/4 TURN INCREMENTS ALLOWING 30 SECONDS BETWEEN ADJUSTMENTS UNTIL PROPER CONSISTENCY OF FOAM IS ACHIEVED.
 - D. IF THE VALVE IS OPEN TOO FAR IT CAN CAUSE THE PUMP TO STALL OUT. IF THIS OCCURS BEGIN AGAIN WITH STEP A.

AFTER USE INSTRUCTIONS

1. IT IS RECOMMENDED TO RUN A GALLON OF FRESH WATER THROUGH THE UNIT AFTER EACH USE. WITH THE DISCHARGE BALL VALVE (HV60) OPEN RUN THE UNIT UNTIL THE GALLON OF WATER HAS GONE THROUGH THE UNIT AND DISCHARGED OUT OF THE DISCHARGE HOSE.
2. DISCONNECT THE AIR LINE FROM THE AIR FITTING (AP25) AND RELIEVE ANY REMAINING PRESSURE IN THE SYSTEM BY HAVING THE DISCHARGE BALL VALVE (HV60) IN THE OPEN POSITION.
3. CLOSE THE DISCHARGE BALL VALVE (HV60) WHEN ALL THE PRESSURE IS RELIEVED FROM THE SYSTEM.

ACCEPTABLE PRODUCTS

- ALKALINE CLEANERS
- CAUSTIC CLEANERS
- SANITIZERS
- ACIDS

UNACCEPTABLE PRODUCTS

- D-LIMONENE (OK WITH VITON PUMP ONLY)
- ALL HYDROCARBONS



TROUBLE SHOOTING INSTRUCTIONS

1. CHECK FOR PROPER AIR PRESSURE (60 PSI OR MORE INTO UNIT, 60 PSI ON AG100(AG100) .
2. CHECK AIR INLET FILTER BOWL(ABR15) FOR DEBRIS SUCH AS WATER, OIL,OR RUST PARTICLES CLEAN BY PULLING DOWN ON THE BOTTOM OF THE FILTER.
3. CHECK FOR PLUGGED STRAINER(STR14) . REPLACE STAINER IF NECESSARY, **STRAINER MUST BE USED**
4. IF **WET FOAM/DRY FOAM** VALVE(NV14Y) IS OPEN TOO FAR THE PUMP WILL NOT CYCLE PROPERLY DUE TO LACK OF AIR PRESSURE IF THIS OCCURS, RESET VALVE AS DESCRIBED IN OPERATING INSTRUCTION #4.
5. MAKE SURE PROPER FOAMING CHEMICAL AND CONCENTRATION IS BEING USED.
6. IF AIR PASSES THROUGH THE PUMP WITHOUT CYCLING, REPLACE PUMP.
7. IF FOAM SOLUTION BACKS UP INTO AIR FILTER(ABR15) THE CHECK VALVE(CV38) NEEDS TO BE REPLACED.
8. IF FOAM COMES OUT WET NO MATTER WHERE THE **WET FOAM/DRY FOAM** VALVE IS POSITIONED THE CHECK VALVE(CV38) MAY NEED TO BE REPLACED.
9. IF UNIT FOAMS AT A REDUCED PRESSURE:
 - A. CHECK THE AIR SUPPLY INTO THE UNIT. IF IT IS LOW, TURN THE FOAM UNIT OFF UNTIL THE COMPRESSOR CAN CATCH UP.
 - B. IF THE AIR SUPPLY IS 60 PSI OR ABOVE, CHECK THE AIR GAUGE(AG100) WHICH SHOULD READ NEAR 60 PSI. IF THE GAUGE IS MORE OR LESS THAN 60 PSI, ADJUST THE PRESSURE BY TURNING THE KNOB ON THE TOP OF THE REGULATOR(R15) .
 - C. IF BOTH OF THE ABOVE ARE O.K., THE STAINLESS STEEL MIXING MESH COULD BE PLUGGED. REMOVE AND CLEAN IT FOLLOWING THE INSTRUCTIONS BELOW:
 1. BE SURE THE FOAM UNIT IS NOT PLUGGED INTO AN AIR SUPPLY AND BE SURE TO RELIEVE ALL STORED PRESSURE IN THE UNIT BY HAVING THE DISCHARGE BALL VALVE(HV60) IN THE OPEN POSITION.
 2. REMOVE THE HOSE BARB(HBSS1212) FROM THE TEE(HBSSEL1238) .
 3. REMOVE THE SCREEN AND THE MIXING MESH FROM INSIDE THE TEE(HBSSEL1238) .
 4. CLEAN ANY PARTICLES FROM THE MIXING MESH AND THE SCREEN.
 5. REPLACE THE MIXING MESH THEN THE SCREEN INTO THE BACK OF THE TEE(HBSSEL1238) AND SCREW THE HOSE BARB(HBSS1212) BACK INTO THE TEE(HBSSEL1238) . (IT IS RECOMMENDED TO USE A PIPE THREAD SEALANT WHEN REINSTALLING THE HOSE BARB INTO THE TEE). **NOTE:** IF THE MIXING MESH HAS A LOT OF FOREIGN PARTICLES IN IT, MAKE SURE THE STRAINER IS STILL IN PLACE(STR14) .